



SOP on Vehicle Tagging by Empanelled Rice Mills



Ver. 1.0

Date of Release: 25.10.24

A Rice Mill has to place a vehicle to a Purchase Centre to carry the day's purchase to the Rice Mill. Now, this system is automated in <https://epaddy.wb.gov.in/>. A Rice Mill user in his login will do the following work:

1. The Rice Mill will go to the menu 'Enter Registration no. of Vehicle'. In the given box, he will enter the registration no. of the vehicle at his disposal and click 'Submit' button.

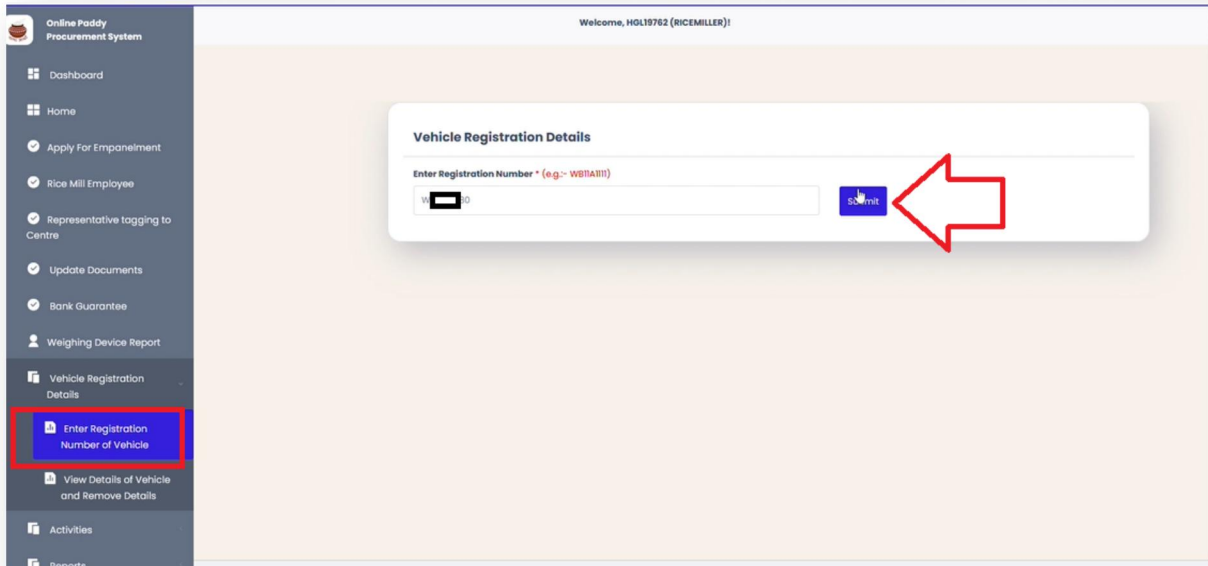

2. The details of the vehicle will be fetched from Unified Logistics Interface Platform. If the given vehicle is a goods vehicle, its insurance is up to date and the registration is active, it will be deemed a suitable vehicle. The Rice Mill will click the 'Confirm Details'.

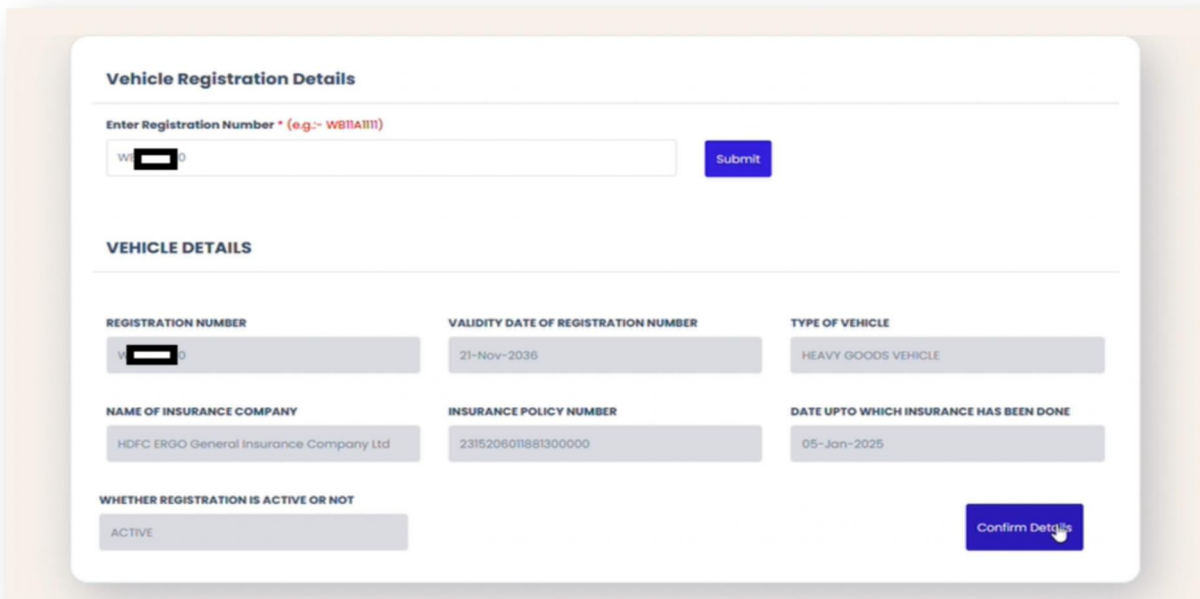



SOP on Vehicle Tagging by Empanelled Rice Mills



Ver. 1.0

Date of Release: 25.10.24

- The vehicle, if suitable, will be added.

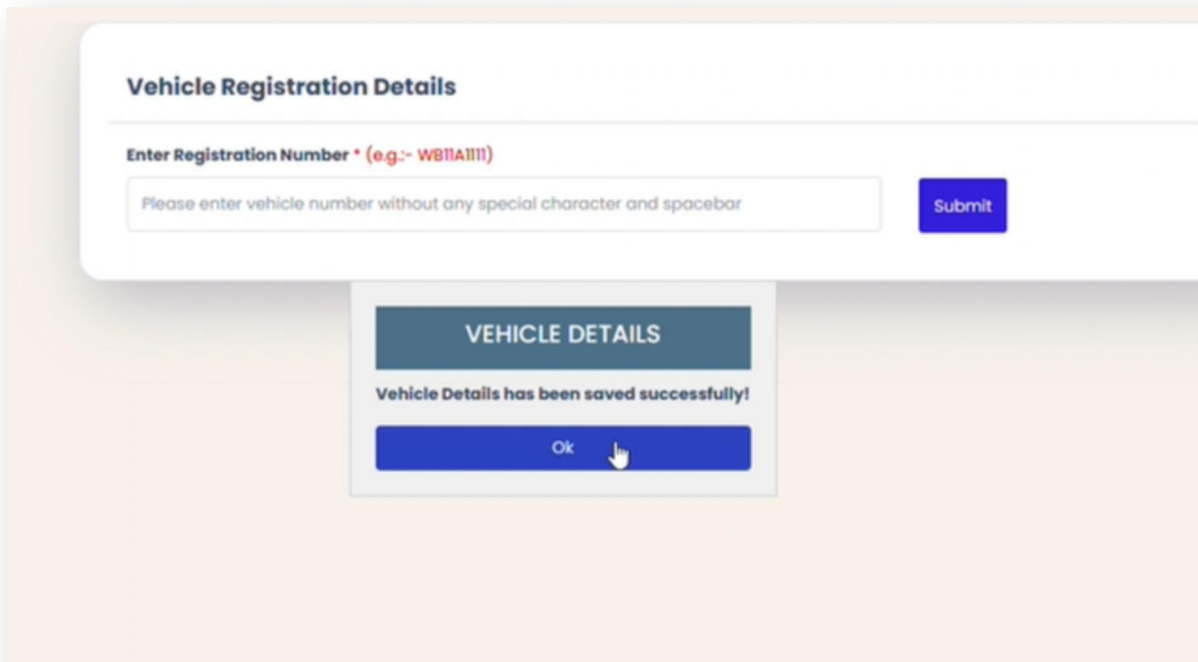

- The Rice Mill at any point of time can view the vehicles added by him. For this he will go to 'View Details of Vehicle and Remove Vehicle' menu. All the vehicles currently tagged will be shown. If he wishes to remove any vehicle, he will click 'De-tag Vehicle' button.

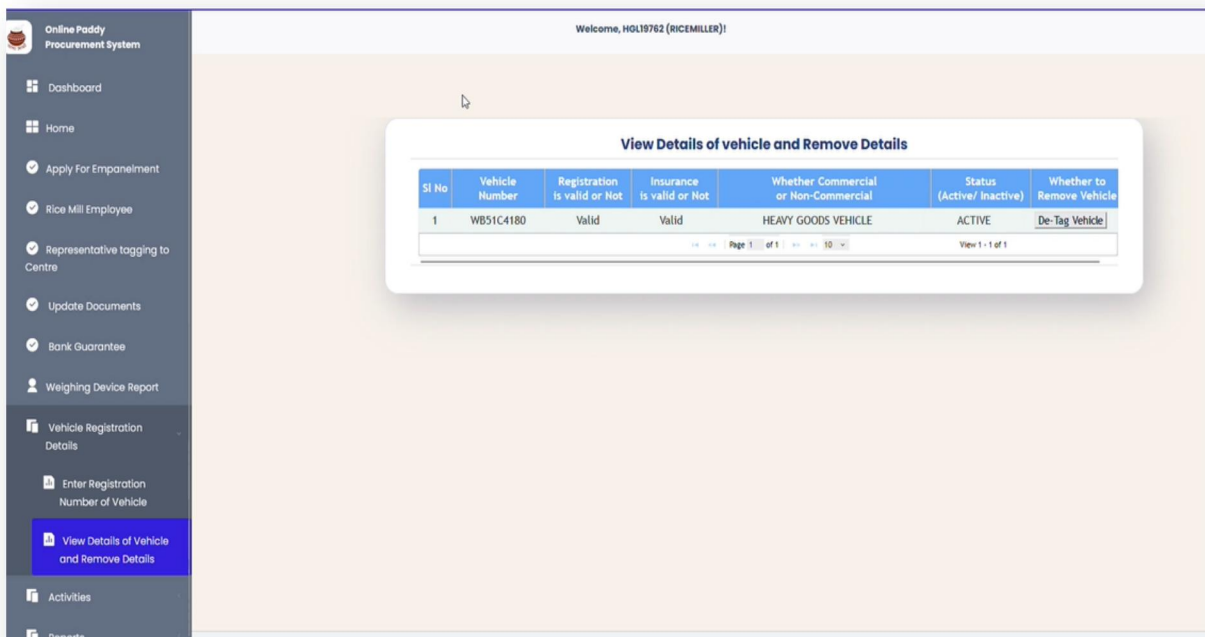



SOP on Vehicle Tagging by Empanelled Rice Mills



Ver. 1.0

Date of Release: 25.10.24

5. He will be asked to confirm whether he wants to remove the vehicle.

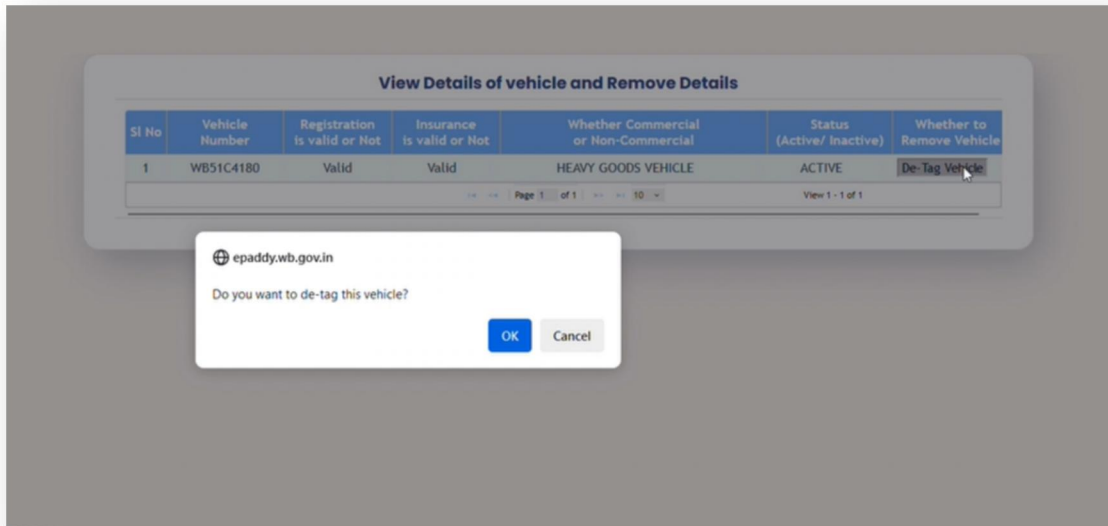

6. When he clicks 'OK', the vehicle will be removed.

